

**MOTOR SPECIFICATION SHEET**

MODEL : SF-J 50HP 2P (LT)

USED FOR : STANDARD

| DESCRIPTION                      | DETAIL  |      |      |      |      |
|----------------------------------|---|------|------|------|------|
| PHASE                            | 3   |      |      |      |      |
| MODEL NAME                       | SF-J  |      |      |      |      |
| RATED OUTPUT, HP (kW)            | 50 (37)   |      |      |      |      |
| POLE                             | 2   |      |      |      |      |
| CODE                             | MEATH CODE : 1M002F-203750J-FY0                     |      |      |      |      |
| OUTLINE DRAWING NO.              | OMM44O026-C   |      |      |      |      |
| RATED VOLTAGE (V)                | 220   | 380  | 415  | 220  | 440  |
| RATED FREQUENCY (Hz)             | 50  | 50   | 50   | 60   | 60   |
| RATED CURRENT (A)                | 120   | 69   | 67   | 116  | 60   |
| RATED SPEED (min <sup>-1</sup> ) | 2920  | 2920 | 2940 | 3510 | 3530 |
| THERMAL CLASS                    | 155(F)  |      |      |      |      |
| RATING                           | S1 (CONTINUOUS)                                     |      |      |      |      |
| ENCLOSURE CONSTRUCTION           | TOTALLY ENCLOSED FAN COOLED                         |      |      |      |      |
| DEGREES OF PROTECTION            | IP55  |      |      |      |      |
| METHOD OF COOLING                | IC411   |      |      |      |      |
| FRAME NO.                        | 200L  |      |      |      |      |
| WEIGHT (kg)                      | 280   |      |      |      |      |
| STANDARD                         | IEC 60034-1, JEC-2137-2000                          |      |      |      |      |
| INSTALLATION                     | FOOT MOUNTED  |      |      |      |      |
| ROTATION                         | CCW (VIEWED FROM SHAFT END)                         |      |      |      |      |
| BEARING                          | LOAD SIDE : 6312ZZC3                                |      |      |      |      |
|                                  | OPPOSITE SIDE : 6311ZZC3                            |      |      |      |      |
| BEARING GREASE                   | UREA GREASE   |      |      |      |      |
| NOISE (dB.A)                     | 91  |      |      |      |      |
| VIBRATION                        | V15   |      |      |      |      |
| CIRCUMSTANCE<br>CONDITION        | AMBIENT TEMPERATURE : -20 ~ +40°C                   |      |      |      |      |
|                                  | AMBIENT HUMIDITY : 95%RH OR LESS                    |      |      |      |      |
|                                  | ABOVE SEA LEVEL : 1000m OR LESS                     |      |      |      |      |
|                                  | ENVIRONMENT : NO BURSTING/EROSIVE GAS OR VAPOR      |      |      |      |      |
| COLOR                            | MUNSELL N5.5 (GRAY)                                 |      |      |      |      |
| TERMINAL BOX                     | NO. OF LEAD WIRES : 6                               |      |      |      |      |
|                                  | SOURCE CONNECTION : LEAD WIRES                      |      |      |      |      |
| INSULATION RESISTANCE            | BY DC 500V MEGGER - ≥100MΩ                          |      |      |      |      |
| DIELECTRIC TEST                  | AC 50Hz 1800V - 1min. (Based on rated voltage 380V) |      |      |      |      |
| SHAFT SWING                      | ≤0.05mm   |      |      |      |      |
| MATERIAL                         | FRAME : CAST IRON                                   |      |      |      |      |
|                                  | BRACKET : CAST IRON                                 |      |      |      |      |
|                                  | SHAFT : CARBON STEEL                                |      |      |      |      |
|                                  | STATOR CORE : ELECTRICAL STEEL                      |      |      |      |      |
|                                  | WIRE : ENAMELLED COPPER MAGNET WIRE                 |      |      |      |      |
|                                  | INSULATOR : POLYESTER FILM SATURATED WITH RESIN     |      |      |      |      |
|                                  | VARNISH : EPOXY DENATURALIZATION POLYESTER          |      |      |      |      |
|                                  | ROTOR CORE : ELECTRICAL STEEL                       |      |      |      |      |
|                                  | CONDUCTOR : ALUMINIUM                               |      |      |      |      |
|                                  | TERMINAL BOX : CAST IRON                            |      |      |      |      |
|                                  | PAINTING : POLYURETHANE RESIN                       |      |      |      |      |
| PRODUCTION COUNTRY               | THAILAND  |      |      |      |      |

Specifications subject to change without notice.

|                                |  |  |  |  |
|--------------------------------|--|--|--|--|
| <b>SPECIFICATION SHEET NO.</b> |  |  |  |  |
| SS-M-4142-B                    |  |  |  |  |

# MODEL SF-J THREE PHASE INDUCTION MOTOR OUTLINE DRAWING

TOTALLY ENCLOSED FAN COOLED  
 DEGREES OF PROTECTION IP55  
 DUST & WATER JET PROOF

CUSTOMER \_\_\_\_\_  
 USER \_\_\_\_\_  
 FOR \_\_\_\_\_  
 CUSTOMER'S ORDER NO. \_\_\_\_\_  
 QUANTITY \_\_\_\_\_  
 MFG. ORDER NO. \_\_\_\_\_

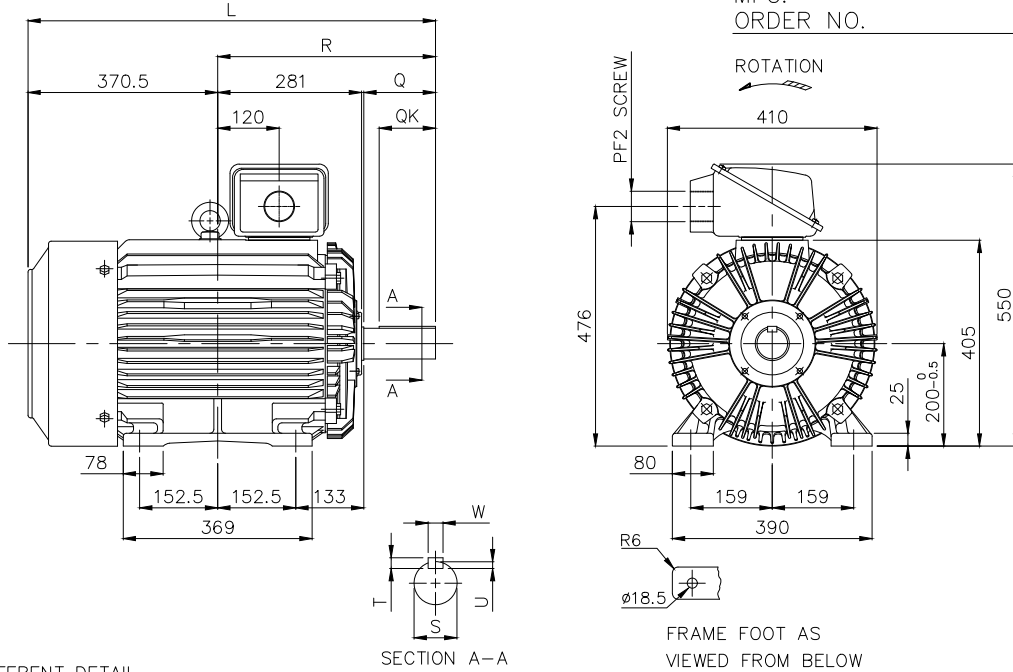

DIFFERENT DETAIL

| POLE  | BEARINGS  |           | DIMENSION |     |     |       |   |    |   |    |
|-------|-----------|-----------|-----------|-----|-----|-------|---|----|---|----|
|       | LOAD SIDE | OPP. SIDE | L         | Q   | QK  | R     | S   | T  | U | W  |
| 2P    | 6312ZZC3  | 6311ZZC3  | 766       | 110 | 90  | 395.5 | ø55m6 <sup>+0.030</sup> / <sub>+0.011</sub> | 10 | 6 | 16 |
| 4P,6P | 6313ZZ    | 6311ZZ    | 796       | 140 | 110 | 425.5 | ø60m6 <sup>+0.030</sup> / <sub>+0.011</sub> | 11 | 7 | 18 |

| YOUR ORDER | FRAME SIZE | RATING     | TH. CLASS | AMB. TEMP. | COLOR               | DIRECTION OF ROTATION (VIEWED FROM SHAFT END) | NO. OF LEAD WIRES | REMARKS |
|------------|------------|------------|-----------|------------|---------------------|---|-------------------|---------|
|            | 200L       | S1 (CONT.) | 155(F)    | 40°C       | GRAY (MUNSELL N5.5) | CCW   | 6                 |         |

| YOUR ORDER | OUTPUT |    | POLES       | VOLT        | HERTZ | REMARKS |
|------------|--------|----|-------------|-------------|-------|---------|
|            | HP     | kW |             |             |       |         |
| LT         | 50     | 37 | 2           | 220/380/415 | 50    |         |
|            |        |    |             | 220/440     | 60    |         |
|            | 60     | 45 | 2           | 220/380/415 | 50    |         |
|            |        |    |             | 220/440     | 60    |         |
|            | 50     | 37 | 4           | 220/380/415 | 50    |         |
|            |        |    |             | 220/440     | 60    |         |
| 60         | 45     | 4  | 220/380/415 | 50          |       |         |
|            |        |    | 220/440     | 60          |       |         |
| HT         | 40     | 30 | 6           | 220/380/415 | 50    |         |
|            |        |    |             | 220/440     | 60    |         |
|            | 50     | 37 | 6           | 220/380/415 | 50    |         |
|            |        |    |             | 220/440     | 60    |         |
|            | 50     | 37 | 2           | 380/415     | 50    |         |
|            |        |    |             | 380/440     | 60    |         |
| 60         | 45     | 2  | 380/415     | 50          |       |         |
|            |        |    | 380/440     | 60          |       |         |
| 50         | 37     | 4  | 380/415     | 50          |       |         |
|            |        |    | 380/440     | 60          |       |         |
| 60         | 45     | 4  | 380/415     | 50          |       |         |
|            |        |    | 380/440     | 60          |       |         |
| 40         | 30     | 6  | 380/415     | 50          |       |         |
|            |        |    | 380/440     | 60          |       |         |
| 50         | 37     | 6  | 380/415     | 50          |       |         |
|            |        |    | 380/440     | 60          |       |         |

MITSUBISHI ELECTRIC AUTOMATION (THAILAND) CO., LTD.

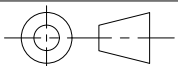

DIMENSION IN mm.

SCALE : NTS

OUTLINE DRAWING NO.

0 M M 4 4 0 0 2 6

REV.

C